

KEY MAP
N.T.S.

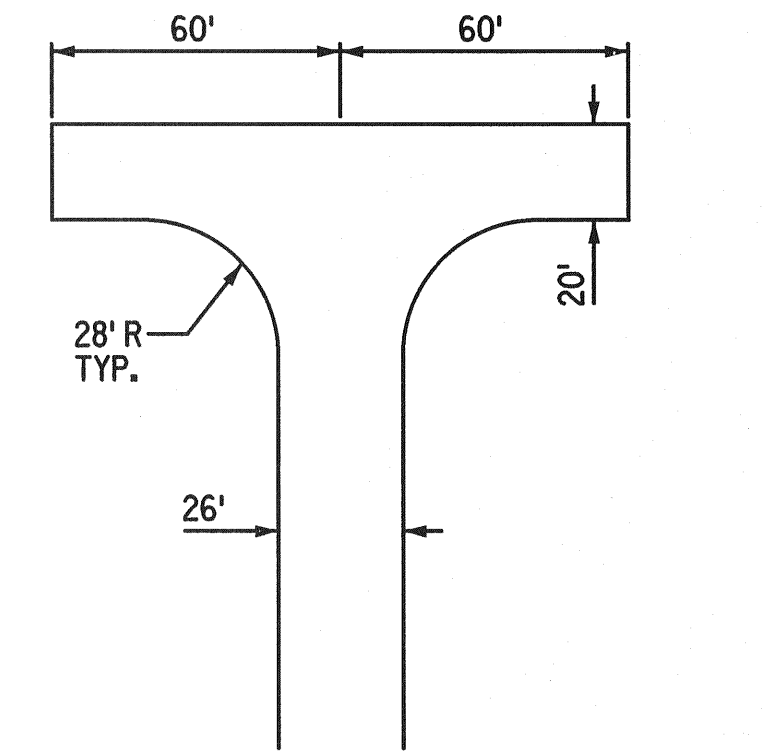

120' HAMMERHEAD
ACCESS ROAD TURN AROUND

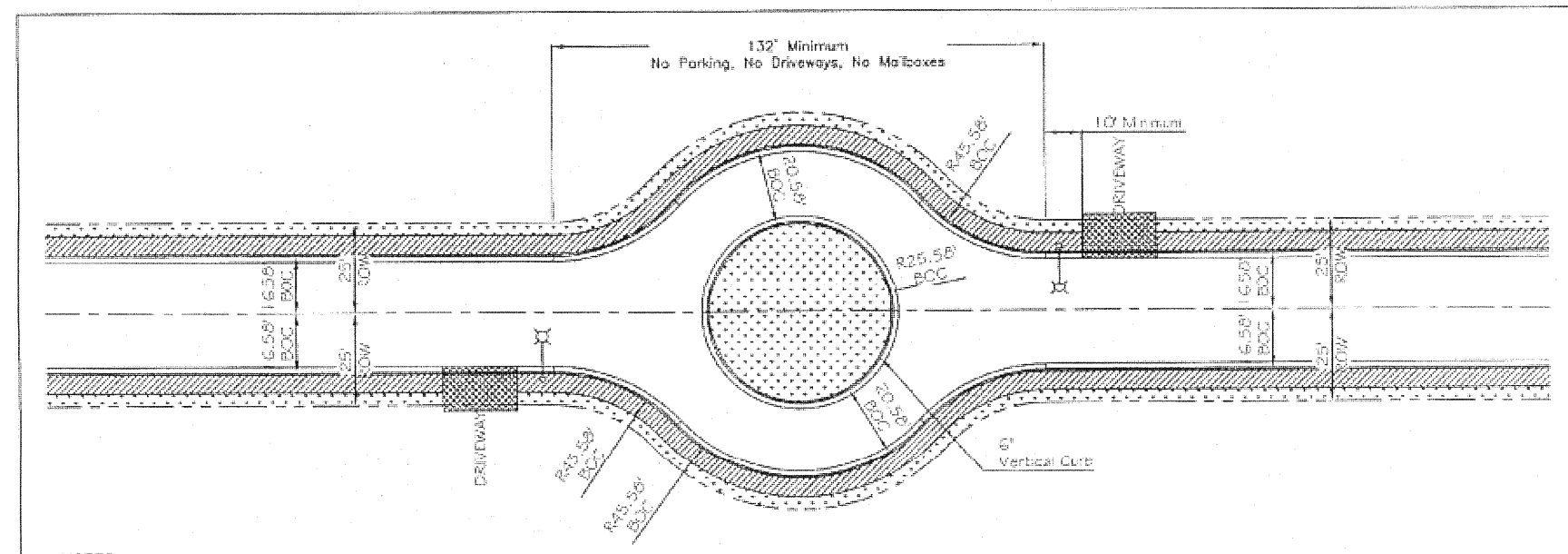

- NOTES
- Drainage must be accommodated.
 - Streetlight(s) will be placed in the vicinity of the baseball field with Street Transportation Dept. Streetlighting Section approval.
 - Streetlights to be placed 4' behind curb.
 - No driveways may be placed within the baseball field and must be a minimum of 10' from the transition.
 - Community mail boxes will not be placed within the baseball field and must be placed at least twenty (20) feet from the transition.
 - All landscaping within the baseball field shall meet City guidelines and will be maintained by the Homeowners' Association.
 - No Parking will be allowed within the baseball field.
 - Baseball must be placed at least 300' from nearest traffic calming device.
- LEGEND
- 6" Vertical Curb
 - Driveway
 - Sidewalk
 - Planter

DETAIL NO. P1282	City of Phoenix STANDARD DETAIL	TRAFFIC CALMING DEVICES - NEW CONSTRUCTION LOCAL STREET BASEBALL ADJACENT SIDEWALK	APPROVED CITY ENGINEER 08-08-03 DATE	DETAIL NO. P1282
---------------------	------------------------------------	--	---	---------------------

TWO WORKING DAYS BEFORE YOU DIG
CALL FOR THE BLUE STAKES
1-800-STAKE-IT
Blue Stake Center
1-800-782-5348

Hoskin • Ryan Consultants, Inc.
creative engineering solutions



201 W. Indian School Road
Phoenix, AZ 85013-3203
Office (602) 252-8384 | Fax (602) 252-8385 | www.hoskinryan.com

REVISIONS:

SUNLAND ESTATES

TENTATIVE MAP

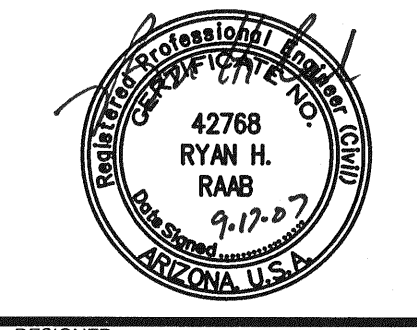

DESIGNED:	DRAWN: STAFF
CHECKED:	PLOT DATE: 8/12/07
SHEET 2 OF 17	
PROJECT NO. 07-005	

Land Planning • Hydrology • Land Development • Civil Infrastructure • Surveying